

Incredible **100,000 hrs**

GENERAL DESCRIPTION

Neptun's Induction 22" Polycarbonate High/Low-Bay fixtures with battery backup system combine classic form and versatility to make it an excellent choice for new construction or retrofit applications. The polycarbonate refractor offers excellent optics with horizontal and vertical footcandles. The 40W battery backup system allows up to 90 minutes of emergency operation. It can replace existing HID & HPS fixtures up to 400W.

APPLICATION

- Warehouse Lighting
- Factory Lighting
- Retail Lighting
- Showroom Lighting
- Grocery Store Lighting
- Area & Storage Lighting
- Gymnasium Lighting

STRUCTURE, MATERIALS, & FEATURES

- 22" High Efficiency, heat and impact resistant, UV protected, non yellowing, polycarbonate refractor.
- Corrosion resistant die-cast aluminum gear box with white electrocoat finish.
- Inductively coupled circular induction bulb.
- High power factor, low THD electronic ballast with surge protection.
- 40W battery backup induction bulb with automatic instant start system.
- Ni-Cad battery system with 24VDC operation.
- Separate surface mount cast aluminum battery system gear box.
- Instant-On flicker-free Cold Start and Hot Re-Start.
- High quality glare-free light with high CRI above (83).
- Bright white light (5000°K) for greater visibility and safety.
- Advance phosphors for high lumen output and high lumen maintenance.
- Up to 20 year maintenance free operation.
- 10 Year Warranty.

ORDERING INFORMATION

Sample Number: 19200-PC-UNV-40BB-120V-850-MD-WG-C3
 Custom options and accessories available. Please consult factory

Series	Wattage	Reflector	Voltage	System	CCT	Accessories	Options
19 = High Bay	200 = 200 W 250 = 250 W	PC = Polycarbonate	UNV = 120-277 VAC 347V = 347 VAC 480V = 480 VAC	40BB-120V = 40W Battery Backup - 120V 40BB-277V = 40W Battery Backup - 277V	830 = 3000°K 841 = 4100°K 850 = 5000°K * * Standard	LD-120V = Photocell 120V LD-277V = Photocell 277V MD = Motion Sensor * Ships pre-installed	C3* = 3' Cord-No Plug PC3 = 3' Cord with NEMA Plug PL = Polycarbonate Lens WG = Wire Guard * Standard ** Fixture ships with glass lens



lightinnovations@work™

PRODUCT INFORMATION

Model No.	Description	Rated Watts	Input Watts	Initial Lumens	Line Voltage (VAC)	Max Line Current (Amp) @ 120 - 277	THD	Power Factor	Weight
19200-PC-UNV	22" High-Bay Fixture	200	210	16,000	120-277	1.75-0.75	<10%	0.98	28 lbs
40BB	40W Battery Backup	40	41	3,200	120 or 277	0.36 / 0.15	<10%	0.98	15 lbs
19250-PC-UNV	22" High-Bay Fixture	250	262	20,000	120-277	2.18-0.94	<10%	0.98	28 lbs
40BB	40W Battery Backup	40	41	3,200	120 or 277	0.36 / 0.15	<10%	0.98	15 lbs

SPECIFICATIONS

- Ballast Type Electronic
- Start Method InstantON
- Hot Re-start InstantON
- Universal Input Line Voltage 120-277 VAC
- Input Line Frequency 50/60 Hz
- Lamp Operating Frequency 250 kHz
- Ballast Off-State Draw 0 Watts
- Sound Rating Class A
- ANSI Surge Protection Class A
- Lamp / Ballast System Life 100,000 Hrs.
- Lumen Maintenance @75,000Hrs > 70%
- Color Temperature 5000°K
- Color Rendering Index (CRI) 83
- Minimum Starting Temperature -30°F
- Maximum Starting Temperature 160°F
- Lumens per Watt 80
- Shock / Vibration Resistant Yes
- Power Factor > 0.98
- Total Harmonic Distortion < 10%
- Inrush Current Peak < 10 Amp
- ETL Listed / UL Standard 1598 Yes
- FCC Compliance Part 18, Subp. C
- IP Rating IP43
- Warranty 10 Year

BATTERY BACKUP SYSTEM

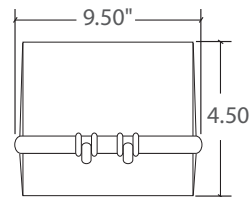
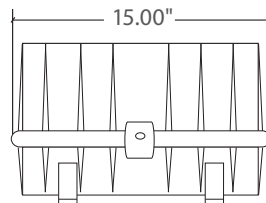

Surface Mount

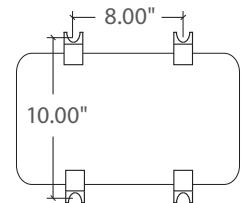

MOUNTING OPTIONS

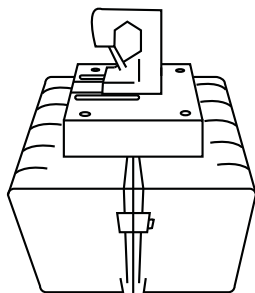

Hook Mount (Standard)

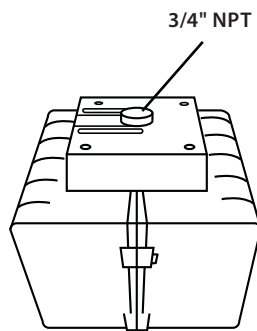

Pendant Mount

PHOTOMETRICS (See Complete IES File)

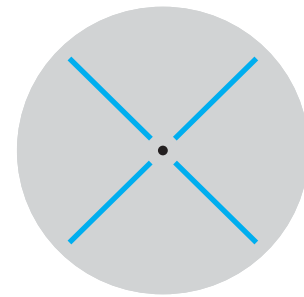

Type V Distribution

Neptun Light, Inc.
13950 Business Center Drive
Lake Forest, IL 60045
Fax: 847.735.8004

Neptun Light, Inc. reserves the right to change materials or modify the design of its product without notification as part of the company's continuing product improvement program.
©2002-2016 Neptun Light, Inc. All rights reserved. Spec. Rev. 4-2016